

# Spoilsport - Vessel Plans

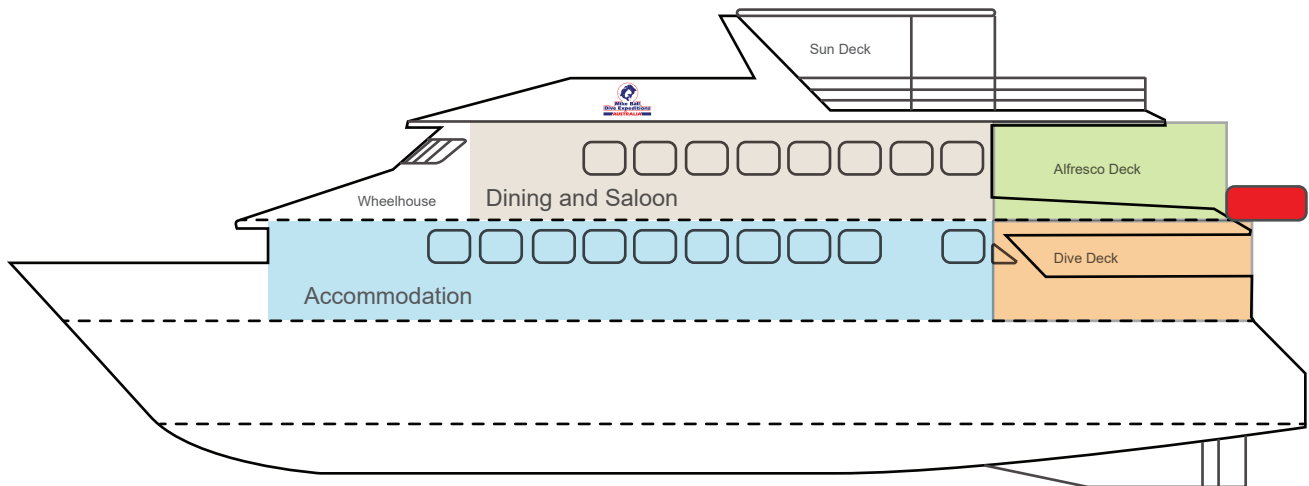

Profile

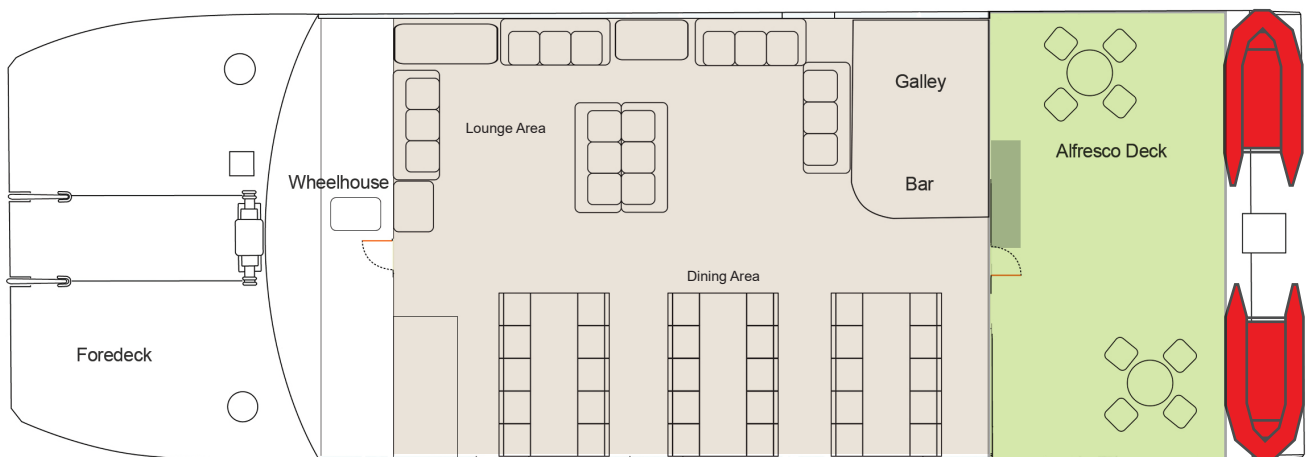

Dining and Saloon

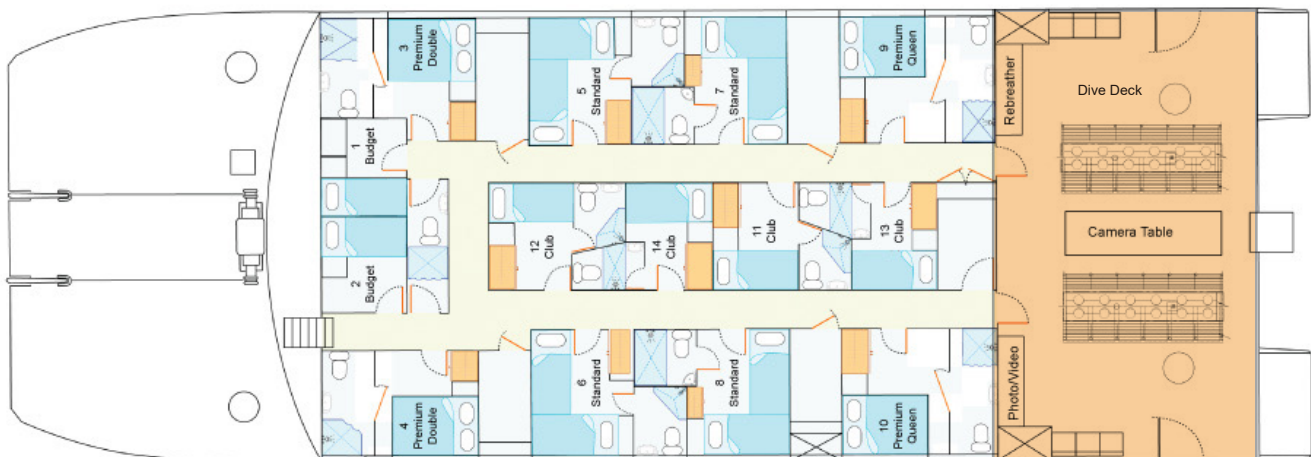

Accommodation

# Spoilsport

## Accommodation

Passenger average 22 (max 28) Crew 12  
Twin hull's reduce seasickness & maximise stability  
2 Large inflatables  
Daily cabin service

## Dive Services

Nitrox  
Solo diving  
Open dive deck  
Camera table  
Rebreather service  
Help for novices  
Freedom for experienced divers  
Digital photo shoot-out on every expedition

## Guest Facilities

Air-conditioned accommodation, lounge & bar, sundeck, alfresco deck, music / DVD player, large screen TV x 2, daily cabin service

## Accommodation

4 x Premium - 2 x queen, 2 x double with private bathroom and ocean view  
4 x Standard - twin beds with private bathroom and ocean view  
4 x Club - twin bunk beds, private bathroom  
2 x Budget - bunks beds, shared bathroom

## Spoilsport Bedding Dimensions

### Premium Cabin

Cabin 9 - queen bed L 2030 x W 1530  
Cabin 10 - queen bed L 2030 x W 1530  
Cabin 3 - double bed L 1840 x W 1370  
Cabin 4 - double bed L 1860 x W 1370

### Standard Cabin

Cabin 5, 6, 7 & 8  
Window - single beds L 2000 x W 890  
Wall - single beds L 1960 x W 890

### Club Cabin

Cabin 11, 12, 13 & 14 - bunk beds L 1900 x W 890

### Budget Cabin

Cabin 1 & 2 - bunk beds L 1960 x W 890

## Vessel Size

Length - 30 m (100ft) Beam - 10.5m (35ft)  
Range - 1930km (1200miles) Survey - AMSA 1B survey (29 pax)  
commissioned - 1989

## Vessel Equipment

Main engines x2, generators x 2, compressors x 2, air-conditioning system x 2

## Electrical Systems

Radar global positioning, HF & VHF radios, echo sounders x 2, 240V / 110V recharge facilities, weatherfax, sonar

## Crew

Master, Trip Director, Engineer, 1st Mate, Chef, Host, Photo/Video Pro, Dive Master x2,  
General Hands x2

